

# TI

## TEES

### 130r

Ti a 90° con derivazione  
ridotta o ingrandita B1

*Tees 90° reducing or increasing*

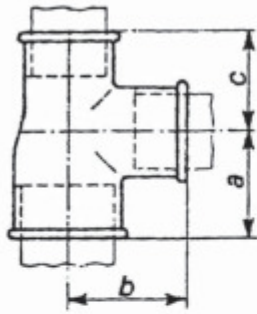

Diametri Ø	Dimensioni / Dimensions mm			Peso / Weight g
	a	b	c	
1/2 x 1/2 x 3/8	30	30	27	134
3/4 x 1/2 x 1/2	33	35	30	169
3/4 x 3/4 x 3/8	36	36	30	200
3/4 x 3/4 x 1/2	36	36	32	205
1 x 1/2 x 1/2	35	36	30	238
1 x 1/2 x 3/4	35	36	33	272
1 x 3/4 x 1/2	38	39	33	260
1 x 3/4 x 3/4	38	39	35	295
1 x 1 x 1/2	40	40	39	-
1 x 1 x 3/4	40	40	39	298
1.1/4 x 1/2 x 1	37	41	37	334
1.1/4 x 3/4 x 3/4	39	44	36	330
1.1/4 x 3/4 x 1	39	44	38	400
1.1/4 x 1 x 1	43	45	40	453
1.1/4 x 1.1/4 x 1/2	48	48	40	482
1.1/4 x 1.1/4 x 3/4	48	48	44	506
1.1/4 x 1.1/4 x 1	48	48	45	545
1.1/2 x 1/2 x 1.1/4	38	43	37	476
1.1/2 x 3/4 x 1.1/4	40	47	39	524
1.1/2 x 1 x 1	45	49	41	516
1.1/2 x 1 x 1.1/4	45	49	43	602
1.1/2 x 1.1/4 x 1.1/4	49	50	48	677
1.1/2 x 1.1/2 x 1/2	53	53	45	525
1.1/2 x 1.1/2 x 3/4	53	53	47	540
1.1/2 x 1.1/2 x 1	53	53	49	646
1.1/2 x 1.1/2 x 1.1/4	53	53	51	725
2 x 3/4 x 1.1/2	43	53	45	726
2 x 1.1/4 x 1.1/4	50	-	48	756
2 x 1.1/2 x 1.1/2	55	58	54	937
2 x 2 x 1	61	61	55	1040
2 x 2 x 1.1/4	61	61	57	1050
2 x 2 x 1.1/2	61	61	58	1060
2.1/2 x 2 x 2	65	71	65	1577
2.1/2 x 2.1/2 x 2	72	72	69	1810